

REVISIONS				
REV.	DATE	DESCRIPTION	ECO	BY
A	1/5/07	PRODUCTION RELEASE	11520	JD
B	08-30-07	UPDATE 3D MODEL & P/N	11698	AK

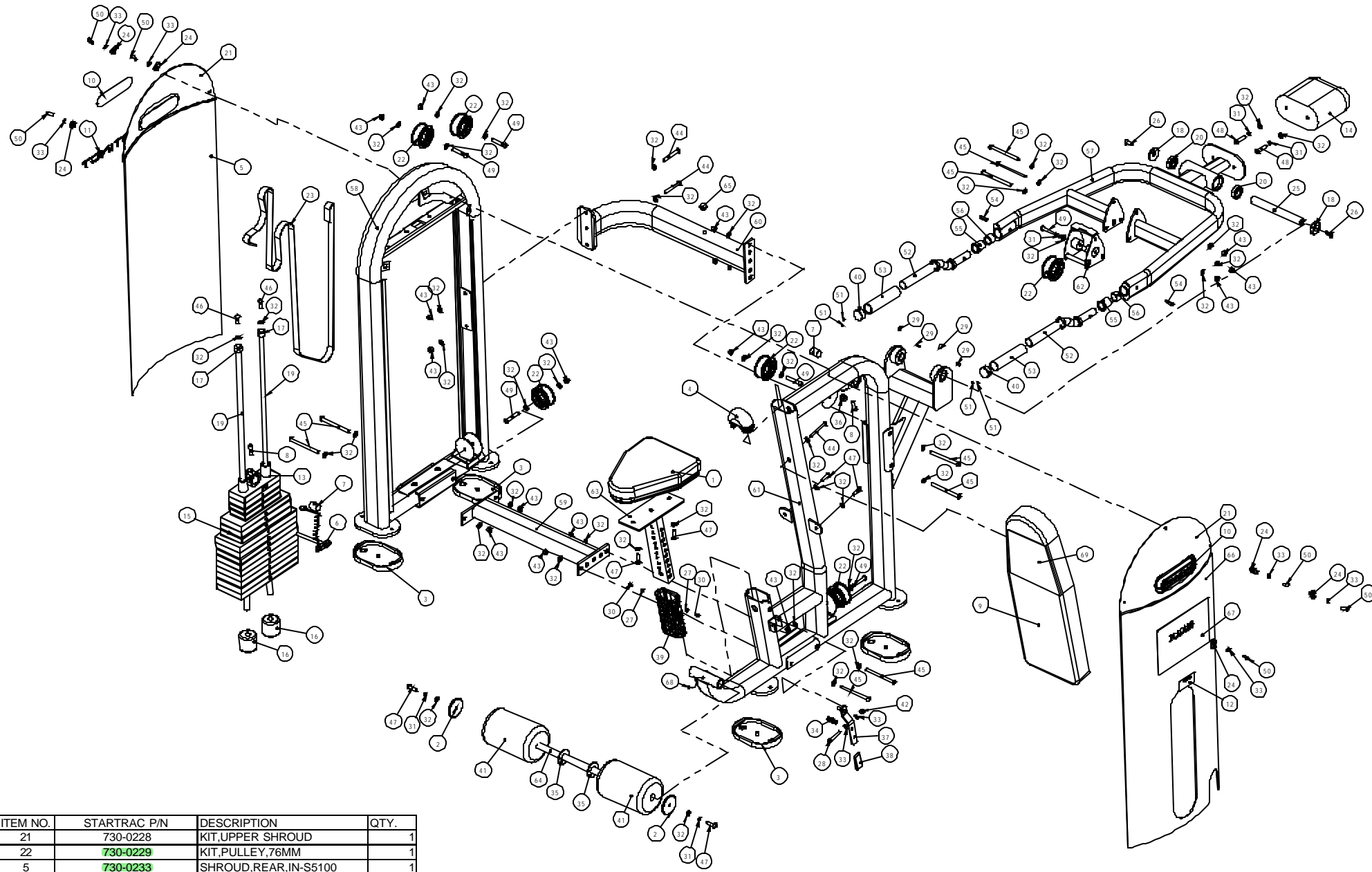

ITEM NO.	STARTRAC P/N	DESCRIPTION	QTY.
21	730-0228	KIT, UPPER SHROUD	1
22	730-0229	KIT, PULLEY, 76MM	1
5	730-0233	SHROUD, REAR, IN-S5100	1
66	730-0319	SHROUD, FRONT, IN-S5130	1
39	730-0213	KIT, SLEEVE, SEAT	1
40	730-0156	KIT, GRIP, 32MM	1
14	730-0551	KIT, COUNTERBALANCE	1
9	730-0246	KIT, SEAT BACK	1
3	730-0216	PAD, FOOT, FRAME, WELDED	1
6	730-0235	ASSY, SELECTOR PIN	1
16	730-0562	BUMPERS, STACK, 60MM	1
1	730-0194	KIT, SEAT	1
23	730-0215	KIT, BELT REPLACEMENT	15.5 FT

ITEM NO.	STARTRAC P/N	INRAY P/N	DESCRIPTION	QTY.
1	730-0194	IN-B72012000	PAD, SEAT, IN-B7201	1
2	730-0200	IT80053800	PLUG, KNEE PAD, 75X10.5, S1012	2
3	730-0216	IN-B75030900	PAD, FOOT, FRAME, WELDED	4
4	730-0233	L1-5000	CAP, LARGE, FRAME	1
5	730-0233	IN-S10121500	SHROUD, REAR, IN-S5100	1
6	730-0235	IN-S10121200	ASSY, SELECTOR PIN	1
7	730-0236	IN-S10121700	PIN, BELT ANCHOR	2
8	730-0237	GB70M10-30A2-70NL	SCREW, M10x30, SHS, SS	2
9	730-0246	IN-S21002200	PAD, BACK, REST, IN-S2100	1
10	730-0383	STARTRAC1	LOGO, STARTRAC	2
11	730-0384	Instinct	LOGO, INSTINCT	1
12	730-0385	CAUTION	LABEL, CAUTION, PINCH POINT	1
13	730-0522	730-0522	ASSY, TOP PLATE, 15 HOLES, IN	1
14	730-0551	IN-S33101400	COUNTERBALANCE, IN-S3310	1
15	730-0555	XZT190	WSR, MAIN, (WS31 + (3 x WS5))	1
16	730-0562	IN-D10132900	BUMPER, STACK, 60MM	2
17	730-0565	IT80129500	CAP, END, HANDLE	2
18	730-0566	IN-S51102100	CAP, 50MM OD	2
19	730-0562	IN-S21001300	WEIGHT, STACK, GUIDE RAIL	2
20	730-0630	GB2746005-2Z	ISO 15 RBB - 1025 - 14, SI, NC, 14, 66	2
21	730-0702	IN-D10132800	SHROUD, UPPER	2
22	730-0721	IN-S51101000	PULLEY, 75MM	6
23	730-0726	IN-S10122000	BELT	1
24	730-0845	IN-S21004800	SHROUD, MOUNTING, U-STYLE, CLIP	6
25	730-0846	IN-S33200800	SHAFT, 25MM X 234	1
26	730-0870	CNLM10-25A2-70	SCREW, M10X25, FHM, HK, SS	2
27	730-0885	GB41M6A2-70	NUT, M6, JAM, HEX, SS	2
28	730-0892	GB70M8-55A2-70	SCREW, M8X55, SHS, SS	1
29	730-0896	GB77M8-16A2-70	SCREW, M8X16, SET, SS	4
30	730-0899	GB81M6-12A2-70	SCREW, M6X12, BHC, SS	2
31	730-0905	GB938DG12	WASHER, M8, SPLIT, LOCK, SS	5
32	730-0908	GB9510A2-70	WASHER, M10, FLAT, SS	44
33	730-0910	GB958A2-70	WASHER, M8, BELLEVILLE, SS	8
34	730-0911	HF 1642303	ADJUSTMENT, HANDLE, COMPRESSION SPING	1
35	730-0912	HF 1652100	SPACER, 25MM ID, 60MM OD	2
36	730-0913	HF 3574000	BUMPER	1
37	730-0930	IN-B72010600	ASSY, EXTENSION, ADJUSTMENT HANDLE	1
38	730-0935	IN-B72011400	ASSY, ADJUSTMENT, HANDLE, END SLEEVE	1
39	730-0936	IN-B72011700	ASSY, TUBE, INSERT, SLEEVE	2
40	730-0960	IN-B75021300	CAP, HANDLE, GRIP, 33MM	2
41	730-1068	IN-S33101100	ROLLER, LEG, PAD, M140X215	2
42	730-1103	NM8A2-70	NUT, M8, NYLON, PATCH, SS	1
43	730-1104	NM10A2-70	NUT, M10, NYLON, PATCH, SS	16
44	730-1109	PNLM10-80A2-70	SCREW, M10X80, BH, SS	3
45	730-1112	PNLM10-130A2-70	SCREW, M10X130, BH, SS	9
46	730-1116	PNLM10-30A2-70	SCREW, M10, BHC, HK, SS	2
47	730-1119	PNLM10-35A2-70	SCREW, M10x35, BH, SS	6
48	730-1121	PNLM10-45A2	SCREW, M10X45, BHC, SS	2
49	730-1122	PNLM10-63A2-70	SCREW, M10X63, BHC, SS	6
50	730-1138	PNLM8-20A2-70	SCREW, M8X20, BHC, SS	6
51	730-1155	YZGB710-32x3.20S2	SCREW, 10-32X3.2, SET	4
52	730-1258	IN-S51300900	HANDLE, IN-S5130	2
53	730-1259	IN-S51303500	HANDLE, RUBBER GRIP	2
54	730-1260	GB87910-30D512	SLOTTED SPRING PIN, M5X32	2
55	730-1261	IN-S51304500	FLANGED SLEEVE BEARING, M5X32	2
56	730-1262	IN-S51307500	SLEEVE BEARING, M5X25	2
57	730-1263	IN-S51300500	U-SHAPE HANDLE, IN-S5130	1
58	730-1264	IN-S51300100	WEIGHT, STACK, FRAME	1
59	730-1265	IN-S51300400	CROSSBEAM, LOWER, FRAME	1
60	730-1266	IN-S51300300	CROSSBEAM, UPPER, FRAME	1
61	730-1267	IN-S51300200	ASSY, MAIN, FRAME	1
62	730-1268	IN-S51300600	ASSY, PULLEY, HANDLE	1
63	730-1269	IN-S51300700	ADJUSTMENT, SEAT, POST, IN-S5130	1
64	730-1270	IN-S51300800	PIVOT, SHAFT, M25X570	1
65	730-1271	TAB-3363600	BUMPED, PAD	1
66	730-1272	IN-S51303400	SHROUD, FRONT, IN-S5130	1
67	730-1365	TZ255130	PLACARD, INSTRUCTION, IN-S5130	1
68	730-1405	YZGB710M8x6.20S2	GB_SOCKET_SET_TYPE4 M8x6-N	1
69	730-0321	IN-S21002205	HEAD STRAP, IN-S4100	1

NOTES:

DOCUMENT STATUS:
RELEASE

NOTICE OF PROPRIETARY INFORMATION

THIS DOCUMENT SHALL NOT BE REPRODUCED NOR SHALL THE INFORMATION CONTAINED HEREIN BE USED BY OR DISCLOSED TO OTHER EXCEPT AS EXPRESSLY AUTHORIZED BY UNISEN

MATERIAL
SEE BOM

FINISH

FRAME COLOR: STAR TRAC SILVER (HP FULLER) UPHOLTERY COLOR STAR TRAC GREY (SLATE)

VENDOR: N/A

TOLERANCES UNLESS OTHERWISE SPECIFIED

UNISEN, INC. DBA
STAR TRAC
14410 Myford Road
Irvine CA 92606

DRAWN: AK
CHECKED: AK
APPROVED: AK

DATE: 07/26/07

U.O.M.: MM

SCALE: 1:25

PART NO: 91N-S5130-13BSS

TITLE: IN, SSS, DIP PRESS

SHEET 1 OF 1

SHEET SIZE: B